

**RESOLUTION
NO. 2025-6**

A RESOLUTION OF THE BOARD OF COUNTY COMMISSIONERS OF LOGAN COUNTY, COLORADO, APPROVING REVISED PRECINCT BOUNDARIES AND MAPS FOR ALL GENERAL, PRIMARY AND CONGRESSIONAL VACANCY ELECTIONS.

WHEREAS, Colorado Revised Statutes sections 1-5-101(1) and 1-5-102 provide in part that the county clerk and recorder shall divide the county into as many election precincts as is convenient and expedient for the eligible electors of the county, subject to the approval of the Board of County Commissioners; and

WHEREAS, Colorado Revised Statutes sections 1-5-103, 1-5-104, and 30-11-107(1)(f) authorize the Board of County Commissioners to organize and change boundaries of election precincts for all elections, including partisan and nonpartisan elections; and

WHEREAS, the Logan County Clerk and Recorder has recommended the adoption of a resolution approving precinct boundary changes that are necessitated by annexation of parcels into the municipal boundaries of the City of Sterling, and which is otherwise needed to formally update the county's precinct boundary resolution and make future precinct boundary changes self-effectuating when city annexations occur; and

WHEREAS, Colorado Revised Statutes section 1-5-101(3)(a) provides that the county clerk and recorder, subject to approval by the Board of County Commissioners, may establish one precinct for every two thousand active eligible electors; and

WHEREAS, Colorado Revised Statutes section 1-5-101(3)(b) provides that once the precincts have been established in accordance with subsection 101(3)(a), they need not be modified until the precincts have more than twice as many active eligible electors as they did at the time of the most recent federal decennial census, or when they were established whichever is later; and

WHEREAS, the Logan County Clerk and Recorder has determined that the revised precinct boundaries legally described below and diagrammed in the maps of Logan County and the City of Sterling, which are attached hereto and fully incorporated herein by reference, accurately reflect current City of Sterling municipal boundaries and will create efficiencies in the election and political process as well as convenience in election administration to the extent that Precincts 1-4 (the "city precincts") are readily identified as precincts within the municipal boundaries of the City of Sterling and Precincts 5-9 (the "county precincts") are readily identified as precincts which lie in all other Logan County areas.

NOW, THEREFORE, BE IT RESOLVED by the Board of County Commissioners of Logan County, Colorado, that Logan County election precincts ONE (1) through NINE (9) shall be described as follows:

CITY PRECINCTS –

PRECINCT NO. 1: shall be that area described as follows, to-wit:

Commencing at the corner of West Broadway Street and North Seventh Avenue as the point of beginning; thence Northerly along the City of Sterling western boundary line to County Road 30; thence East on County Road 30 to the City of Sterling boundary line; thence North on the City of Sterling boundary line to Pioneer Road; thence Easterly on Pioneer Road following the City of Sterling northern boundary line to East Hwy 138; thence South along Hwy 138 to Logan Street; thence West on Logan Street to Dawes Street; thence South on Dawes Street to Franklin Street; thence West on Franklin Street to North Division Avenue; thence South on North Division Avenue to Broadway Street; thence West on Broadway Street to the point of beginning.

PRECINCT NO. 2: shall be that area described as follows, to-wit:

Commencing at the intersection of West Broadway Street and North Division Avenue as the point of beginning; thence North along North Division Avenue to Franklin Street; thence East on Franklin Street to Dawes Street; thence North on Dawes Street to Logan Street; thence East on Logan Street and continuing on County Road 30 to the East line of the City of Sterling boundary; thence Southwesterly along the City of Sterling boundary line to Hereford Street; thence West on Hereford Street following the City of Sterling boundary line to Right of Way Road; thence Southwesterly on Right of Way Road following the City of Sterling boundary to the Northwest corner of Lot 30, Sherwin & Barneys 1st Addition; thence East following the City of Sterling boundary line to County Road 370 (Riverview Road); thence following the City of Sterling boundary line to Hwy 6; thence following the City of Sterling boundary line to Hwy 61; thence East on Hwy 61 following the City of Sterling boundary line; thence South following the City of Sterling boundary line to County Road 370; thence following City of Sterling boundary line on the South to County Road 26; thence West on County Road 26 following the City of Sterling boundary line; thence follow the South boundary line of the City of Sterling to Hwy 6 and Division Avenue; thence North on South Division Avenue (becoming North Division Avenue) to the intersection of West Broadway Street, the point of beginning.

PRECINCT NO. 3: shall be that area described as follows, to-wit:

Commencing at the intersection of Hwy 14 and the Southwest corner of Pioneer Park (County Road 35.5); thence North and East on the City of Sterling boundary line around the park to County Road 37; thence North on County Road 37 and East around Lot 1 Emmanuel Southern Baptist Church Subdivision 1st Filing; thence South to Platte Street following the City of Sterling boundary line; thence East on City of Sterling boundary line to the North border of Applewood Subdivision and Sherwood Village Addition to Clark Street Elementary School Addition; thence North following the City of Sterling boundary line to County Road 28 5/10 (turning into West Broadway); thence East on West Broadway to North Division Avenue; thence South on North Division Avenue to Park Street; thence West on Park Street to the City of Sterling boundary line; thence North following the City of Sterling boundary line to South Fourteenth Avenue; thence North on South Fourteenth Avenue to West Main Street; thence West on West Main Street to Ballpark Road (County Road 37); thence South on County Road 37 following the City of Sterling boundary line to HWY 14; thence West on Hwy 14 to the point of beginning.

PRECINCT NO. 4: shall be that area described as follows, to-wit:

Commencing at the intersection of South Division Avenue and Park Street; thence West on Park Street to City of Sterling boundary line; thence South on City of Sterling boundary line to Iris Drive; thence East on Iris Drive to South Ninth Avenue; thence South on South Ninth Avenue following the City of Sterling boundary to Hwy 6; thence South on Hwy 6 to the 21st Century Land LLC Addition; thence following the City of Sterling boundary around the 21st Century Land LLC Addition back to HWY 6; thence Northerly on Hwy 6 to Delmar Street; thence North on South Division Avenue to point of beginning at Park Street.

Excluded from Precinct 4 is the following (unless subsequently annexed into the City of Sterling) 628 Oleander Way as described by Resolution recorded in Book 759 Page 211, 626 Oleander Way as described by Resolution recorded in Book 737 page 884 and all of Koenig Acres Subdivision. The excluded parcels are in Precinct 5 because they are outside of the City of Sterling boundaries.)

PRECINCT NO. 5: shall be that area described as follows, to-wit:

Commencing at the Southeast corner Lot 1 Schaffers Subdivision #1 (County Road 24); thence West along County Road 24 to County Road 33; thence North on County Road 33 to County Road 36; thence East on County Road 36 to County Road 360; thence Southeasterly on County Road 360 to County Road 35; thence North on County Road 35 until it intersects with County Road 36; thence West along County Road 36 until it intersects with County Road 33.7; thence North on County Road 33.7 and continuing until it intersects with County Road 36.2; thence West on County Road 36.2 until becoming County Road 33.5; thence North on County Road 33.5 to County Road 38; thence East along County Road 38 & the North boundary lines of Sec. 5, 4, 3, 2 & 1, T8N R52W to the Northeast corner of Sec. 1; thence South along the East line of Sec. 1, T8N R52W to the Southeast corner; thence East on the North line of Sec. 7, T8N R51W to the Northeast corner of Sec. 7; thence South along the East line of Sec. 7, T8N R51W to I-76 to the City of Sterling boundary line; thence South along I-76 Interstate; thence westerly following around the City of Sterling boundary line to the Southeast corner of Lot 1, Schaffers Subdivision #1 (County Road 24) to the point of beginning.

PRECINCT NO. 6: shall be that area described as follows, to-wit:

Commencing at County Road 2 and County Road 45.5 as the point of beginning; thence West on the South boundary line of Logan County to the Southwest corner of Sec. 31, T6N R54W; thence North on the West line of T6N R54W to the Northwest corner of T6N R54W; thence West on the South line of T7N R55W to the Southwest corner of T7N R55W; thence North on County Road 1 to County Road 26 (Hwy14); thence Easterly on Hwy 14 to County Road 25; thence South on County Road 25 to County Road 26; thence East on County Road 26 to County Road 31; thence North on County Road 31 to Hwy 14; thence East on Hwy 14 to County Road 33; thence South on County Road 33 to County Road 24; thence East on County Road 24 to Hwy 6; thence North on Hwy 6 Easterly around the Southern boundary of the City of Sterling to the Center Line of I-76 Interstate; continuing South on I-76 to the North line of Sec. 31, T7N R52W; thence East on the North line of Sec. 31 to the Northwest corner of Sec. 32; thence Southeast to the Southeast corner Sec. 32; thence East along the South line of Sec. 33, 34 and 35, T7N R52W to County Road 47; thence South on County Road 47 to County Road 8; thence West on County Road 8 until it intersects with County Road 45.5; thence South on County Road 45.5 to County Road 2, the point of beginning.

PRECINCT NO. 7: shall be that area described as follows, to-wit:

Commencing at the intersection of Hwy 14 and County Road 1, the Westerly boundary of Logan County, Colorado as it borders Weld County, Colorado; thence North along said boundary along the County line until it reaches the Nebraska State Line and which is the Northwest corner of Logan County, Colorado; thence East along said state boundary line to the intersection of County Road 71; thence South on County Road 71 until it intersects with County Road 66; thence West on County Road 66 until it intersects with County Road 63; thence South on County Road 63 until it intersects with County Road 64; thence West on County Road 64 until it intersects with County Road 57; thence South on County Road 57 until it intersects with County Road 62; thence West on County Road 62 until it intersects with County Road 55; thence South on County Road 55 until it intersects with County Road 56; thence West on County Road 56 until it intersects with County Road 33; thence South on County Road 33 which turns into County Road 330; thence following County Road 330 until it turns back into County Road 33 and continuing until it intersects with County Road 46; thence East on County Road 46 until it intersects with County Road 37; thence South on County Road 37 until it intersects with County Road 42.5; thence East on County Road 42.5 until it becomes County Road 37.5; thence South on County Road 37.5 to County Road 38; thence West on County Road 38 until it intersects with County Road 33.5; thence South on County Road 33.5 to County Road 36.2; thence East on County Road 36.2 until it becomes County Road 33.7; thence South on County Road 33.7 until it intersects with County Road 36; thence East on County Road 36 to County Road 35; thence South on County Road 35 to County Road 360; thence Northwesterly on County Road 360 to County Road 36; thence West on County Road 36 to County Road 33; thence South on County Road 33 to HWY 14; thence West on HWY 14 to County Road 31; thence South on County Road 31 until it intersects with County Road 26; thence West on County Road 26 until it intersects with County Road 25; thence North on County Road 25 until it intersects with Hwy 14; thence West on Hwy 14 to the point of beginning on County Road 1.



PRECINCT NO. 8: shall be that area described as follows, to-wit:

Commencing at the Northeast corner of Logan County, Colorado where it adjoins the State of Nebraska and Sedgwick County, Colorado as the place of beginning; thence South along the Easterly boundary line of Logan County, Colorado to County Road 46; thence West on County Road 46 to HWY 55; thence South on Hwy 55 to County Road 44; thence West on County Road 44 until it intersects with County Road 77; thence South along County Road 77 to County Road 40; thence West along County Road 40 to County Road 73; thence South on County Road 73 until it intersects with County Road 38; thence West on County Road 38 until it intersects with County Road 67; thence South along County Road 67 until it intersects with the Burlington Northern Railroad; thence following Westerly the Burlington Northern Railroad along the South boundary of Sec. 10, 9 and 8, T8N R51W; thence on the Southwest corner of Sec. 8, T8N R51W; thence North on the West boundary line to the Northwest corner of Sec. 8; thence West on the North line of Sec. 7 to the Northwest corner of Sec. 7; thence North to the Northwest corner of Sec. 6, T8N R51W; thence West on the North line of Sec. 1, 2, 3, 4 and 5, T8N R52W to County Road 37.5; thence North along County Road 37.5 until it becomes County Road 42.5 and continuing West on County Road 42.5 until it intersects with County Road 37; thence North along County Road 37 until it intersects with County Road 46; thence West along County Road 46 until it intersects with County Road 33; thence North along County Road 33 becoming County Road 330; thence following County Road 330 until it becomes County Road 33; thence North on County Road 33 until it intersects with County Road 56; thence East along County Road 56 until it intersects with County Road 55; thence North on County Road 55 until it intersects with County Road 62; thence East on County Road 62 until it intersects with County Road 57; thence North on County Road 57 to County Road 64; thence East on County Road 64 until it intersects with County Road 63; thence North on County Road 63 to County Road 66; thence East on County Road 66 to County Road 71; thence North on County Road 71 to the Nebraska State line; thence due East along the state boundary line to the point of beginning.

PRECINCT NO. 9: shall be that area described as follows, to-wit:

Commencing at the Southeast corner of Logan County, Colorado which is also the intersection of County Road 2 and County Road 97; thence North on County Road 97 and the East County line to County Road 46; thence West on County Road 46 to HWY 55; thence South on HWY 55 to County Road 44; thence West on County Road 44 to the intersection of County Road 77; thence South on County Road 77 to the intersection of County Road 40; thence West on County Road 40 to the intersection of County Road 73; thence South on County Road 73 to the intersection of County Road 38; thence West on County Road 38 to the intersection of County Road 67; thence South along County Road 67 to the Burlington Northern Railroad; thence Westerly along the Burlington Northern Railroad along the South boundary of Sec. 10, 9, and 8, T8N R51W; thence on the Southwest corner of Sec. 8, T8N, R51W; thence North on the West boundary line to I-76 Interstate; thence South on I-76 around the city boundary to the North line of Sec. 31, T7N R52W; thence East on the North line of Sec. 31 to the Northwest corner of Sec. 32; thence Southeast to the Southeast corner of Sec. 32; thence East along the South line of Sec. 33, 34 and 35, T7N R52W to County Road 47; thence South on County Road 47 to County Road 8; thence West on County Road 8 to County Road 45.5; thence South on County Road 45.5 to County Road 2; thence East on County Road 2 to the point of beginning.

BE IT FURTHER RESOLVED that the attached maps of Logan County and the City of Sterling (original maps to be maintained by the Clerk and Recorder), which set forth the boundaries for the election precincts described herein, are adopted and incorporated herein by reference and same shall hereafter be used in conjunction with the precinct boundaries described above to identify all election precincts in Logan County; and in the event there is a conflict between the written descriptions set forth above and said maps, the said maps shall control, and in the event said maps conflict with the official municipal boundary map maintained by the City of Sterling, the map of the City of Sterling shall control.

BE IT FURTHER RESOLVED that future City annexation of land located within county precincts at the time of annexation will cause such annexed land to merge into the corresponding city precinct lying contiguous to it without further approval of the Board, and the Clerk and Recorder shall be authorized to adjust the official precinct maps accordingly.

BE IT FURTHER RESOLVED that this Resolution shall become effective upon adoption and shall remain in effect until amended or repealed by further act of the Board of County Commissioners.

The above and foregoing Resolution was, on motion duly made and seconded, adopted by the following vote on the 21st day of January 2025.

THE BOARD OF COUNTY COMMISSIONERS
OF LOGAN COUNTY, COLORADO



Mike Brownell, Chairman (Aye)(Nay)



Jerry A. Sonnenberg, Commissioner (Aye)(Nay)



James T. Yahn, Commissioner (Aye)(Nay)

I, Pamela M. Bacon, County Clerk and Recorder in and for the County of Logan, State of Colorado, do hereby certify that the foregoing Resolution was duly adopted by the Board of County Commissioners of Logan County, Colorado, in regular session on this 21st day of January 2025.



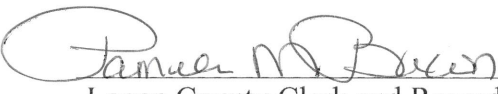

Logan County Clerk and Recorder (seal)

EXHIBIT A

Active voter numbers by precinct

PRECINCT NO.	ACTIVE VOTERS
1	1136
2	1617
3	1960
4	1981
5	1875
6	1196
7	1009
8	1044
9	902

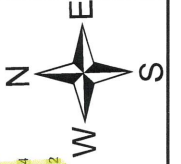

County Precincts

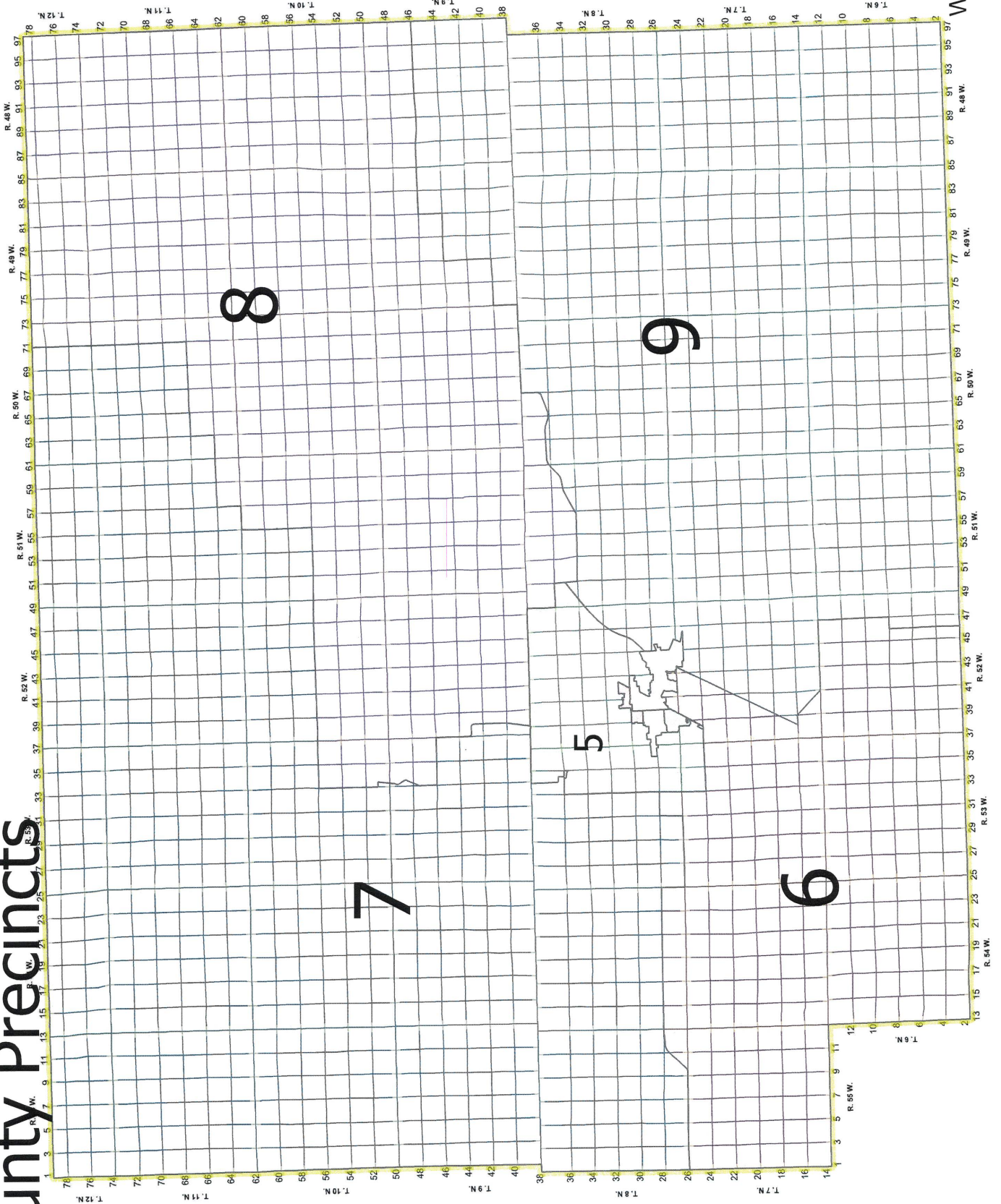

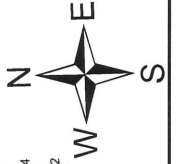

County Precincts

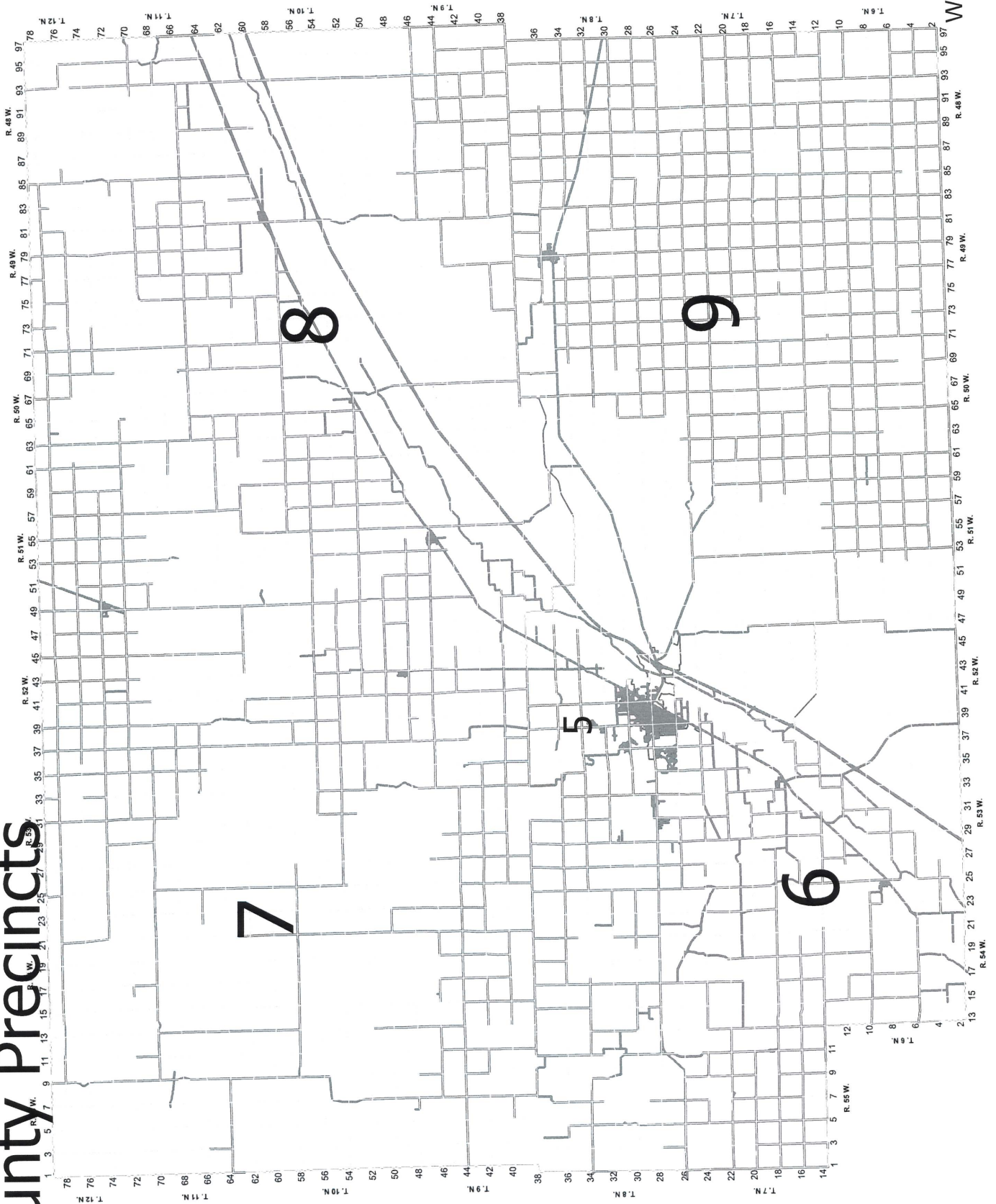

City Precincts

