



<https://logancounty.colorado.gov>

LOGAN COUNTY RIGHT OF WAY PERMIT REQUIREMENTS

1. Applications must be submitted to the Planning & Zoning Department for review and submission to the Board of County Commissioners for approval. The Application must be received by noon on Thursday to be placed on the Commissioner's Agenda for the following Tuesday. Logan County Commissioners meet the first, third and fifth Tuesday morning at 9:30 a.m. unless otherwise advertised.
2. A fee of **\$100.00 (bore)** or **\$200.00 (trench)** will be charged for each request. Please make your checks payable to Logan County.
3. Underground installations should be at 48 inches below the lowest point of the borrow ditch.
4. Please provide a **detailed map** of the proposed Improvements in relation to the surrounding area.
5. A copy of the Application will be forwarded to the Logan County Road & Bridge Department. Logan County Road and Bridge may inspect all work done in the County rights-of-way before, during or after completion.
6. You will be sent copies of the Application and the Logan County Use Tax Agreement after it has been filed in the Logan County Clerk's Office.

REQUEST	FEES
Crossing (Bores)	\$100.00
Crossing (Trench) 1	\$200.00
Driveway Access	\$50.00
Distance The trench will be 30"	</= 1 Mile = \$50 > 1 Mile = \$50.00/Mile or portion thereof
Poles	\$50.00/Mile or portion thereof
Working Prior To Permit Approval (except in case of an approved emergency)	Fees double
Special Circumstances may cause additional fees, which will be considered on a case-by-case basis and approved by the Logan County Commissioners.	

AGREEMENT TO USE LOGAN COUNTY RIGHT OF WAY
INDIVIDUAL PERMIT

THIS AGREEMENT made this (County fills in) _____ day of _____, _____, by and between the County of Logan, State of Colorado, hereinafter called "County", and _____ the undersigned easement holder or landowner, hereinafter called "Applicant".

WHEREAS, Applicant owns the following described premises, or has an easement on, over or through said premises, _____ to-wit _____ (legal _____ description):

_____ ; and

WHEREAS, Applicant desires to install and construct a _____, which will be located (**Circle One**) along, bore under, or trench across _____, to benefit the above described premises; and

WHEREAS, the County is willing to allow such installation and construction by Applicant, but only upon the terms and covenants contained herein.

NOW, THEREFORE, in consideration of paying the County the sum of **\$100.00** or **\$200.00** and keeping of the terms and covenants contained herein, the parties agree as follows:

- Applicant agrees to consult with any irrigation ditch company whose ditch will be crossed by the installation and confer about best practices in performing the installation in a manner that will not damage or weaken any ditch structures.
- Applicant agrees to furnish the County in writing in advance of installation the exact location and dimensions of said installation and construction.
- Buried installations must be at no less than 48 inches below the lowest level of any borrow ditch paralleling the County Road and an "Individual permit" must be submitted for each instance.
- Applicant shall have the right to install and construct _____, described above, in the right of way of _____, but such installation and construction shall be done only in the following manner. All work within the county ROW shall be performed only during regular business hours of the Logan County Road & Bridge Department to enable supervision and inspection of the work.
- All work authorized by this Agreement **shall be completed no later than** _____.
- It is understood that no paved or oil-surfaced road shall be cut and will be crossed by boring only. For other roads and crossings of County property after installation. Applicant shall restore the surface to the same condition as existed prior to such construction.
- All cost and expense of installation, construction, maintenance, removal, or replacement is to be paid by the Applicant.
- The traveling public must be protected during this installation with proper warning signs or signals both day and night. Warning signs and signals shall be installed by and at the expense of Applicant.

- Applicant hereby releases the County from any liability for damages caused by said _____, whether caused by employees or equipment of the County, or others, at any time. Further, Applicant agrees to protect, save and hold harmless, and indemnify the County from and against all liability, loss, damages, personal injuries or expenses suffered by or imposed against the County by reason of the construction, installation or maintenance of the above described improvement.
- No perpetual easement or right of way is granted by this instrument and should Applicant's use of said right-of-way interfere with the County's use, or intended use of said right-of-way, Applicant will remove or relocate the same upon demand of the County. Applicant shall pay all costs of such removal or relocation.
- This Agreement shall be a covenant running with the above-described real property and shall be binding upon the parties hereto, their heirs, successors, personal representatives, and assigns.
- Other _____ Provisions:

Land Owner #1

 Name _____ Printed
 Signature _____

Land Owner #2

 Name _____ Printed
 Signature _____

Individual Right-of-Way Permit Applicant:

 Printed name

 Signature

Address: _____

Application Fee Paid _____

Date _____

Email: _____

Signed at Sterling, Colorado the day and year first above written.

**THE BOARD OF COUNTY COMMISSIONERS
 LOGAN COUNTY, COLORADO**

 Mike Brownell (Aye) (Nay)

 James T. Yahn (Aye) (Nay)

 Jerry A. Sonnenberg (Aye) (Nay)

RIGHT OF WAY INSPECTION FORM
Logan County Road and Bridge
12603 County Road 33
Sterling, CO 80751
970-522-3426

PERMIT
DATE _____

OWNER _____ ADDRESS _____

DESCRIPTION OF WORK _____

TO SCHEDULE AN INSPECTION, PLEASE CALL 970-522-3426 OR 970-520-6370

THE ISSUANCE OR GRANTING OF THIS PERMIT SHALL NOT BE CONSTRUED TO BE A PERMIT FOR, OR AN APPROVAL OF ANY VIOLATION OF ANY OF THE PROVISIONS OF THE ORDINANCES OF LOGAN COUNTY. PERMITS PRESUMING TO GIVE AUTHORITY TO VIOLATE OR CANCEL THE PROVISIONS OF ORDINANCES OF LOGAN COUNTY SHALL NOT BE VALID. THIS PERMIT SHALL EXPIRE IF WORK AUTHORIZED IS NOT COMMENCED WITHIN 180 DAYS OR WORK IS SUSPENDED OR ABANDONED FOR A PERIOD OF 180 DAYS.

Logan County Inspector _____
Date _____

Work By _____ Performed _____

Approved _____ NOT Approved _____
Depth _____

Notes: _____

MAP EXAMPLE

(Please create in Black and White)

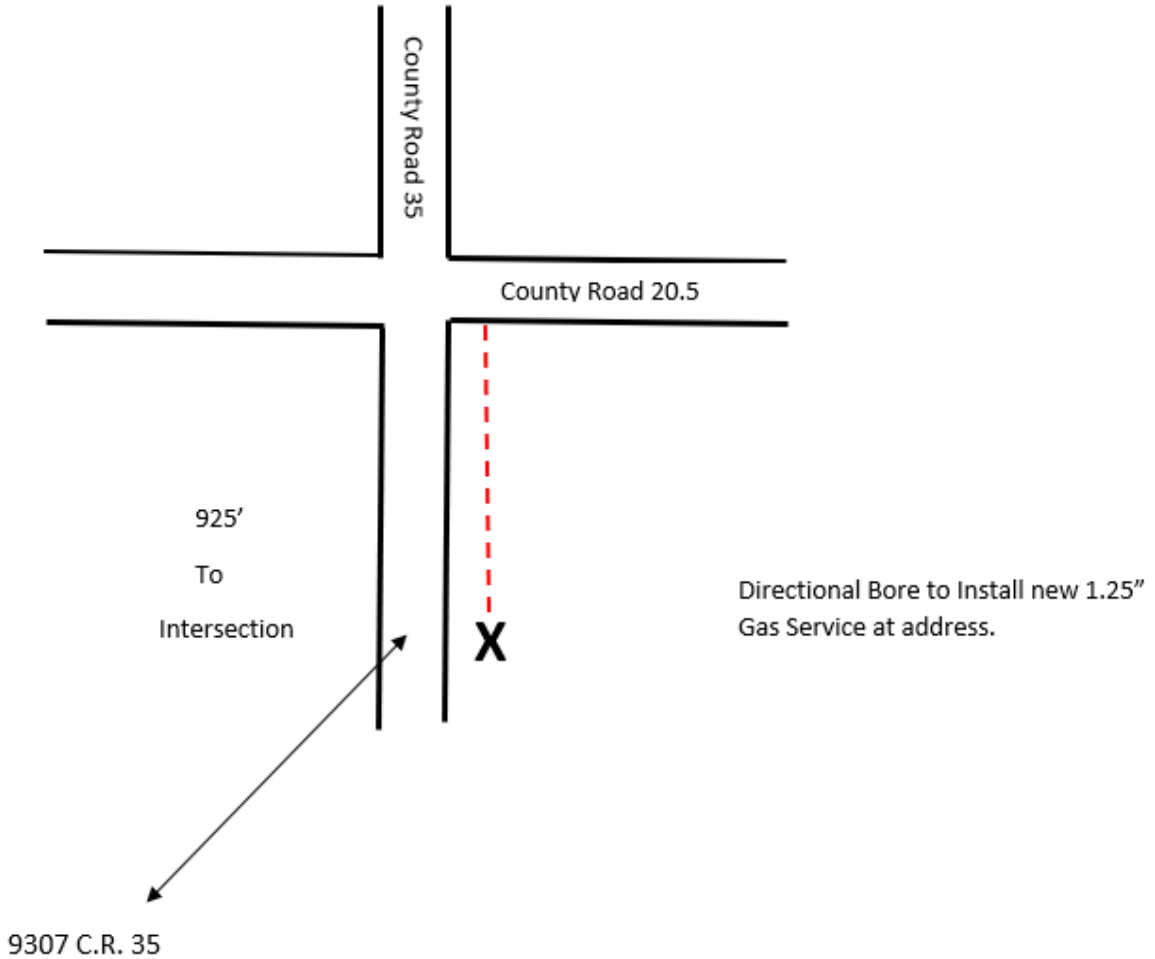

Work will begin at a point (X) 925 feet South of the intersection of County Road 20.5 and County Road 35, on the East side of County Road 35. At this point we will bore under County Road 35, in a Westerly direction.